

Spare parts list for after market.

- You may photocopy this sheet and use it as an order form.
- Sie können dieses Blatt kopieren und als Bestellformular verwenden.
- Vous pouvez photocopier cette feuille et l'utiliser comme bon de commande.
- Dit blad kan gecopieerd en als bestelformulier gebruikt worden.
- Potete fotocopiare questo foglio e usarlo come modulo di commissione.

DEORE XT Front Chainwheel FC-M751

Jul. 1999

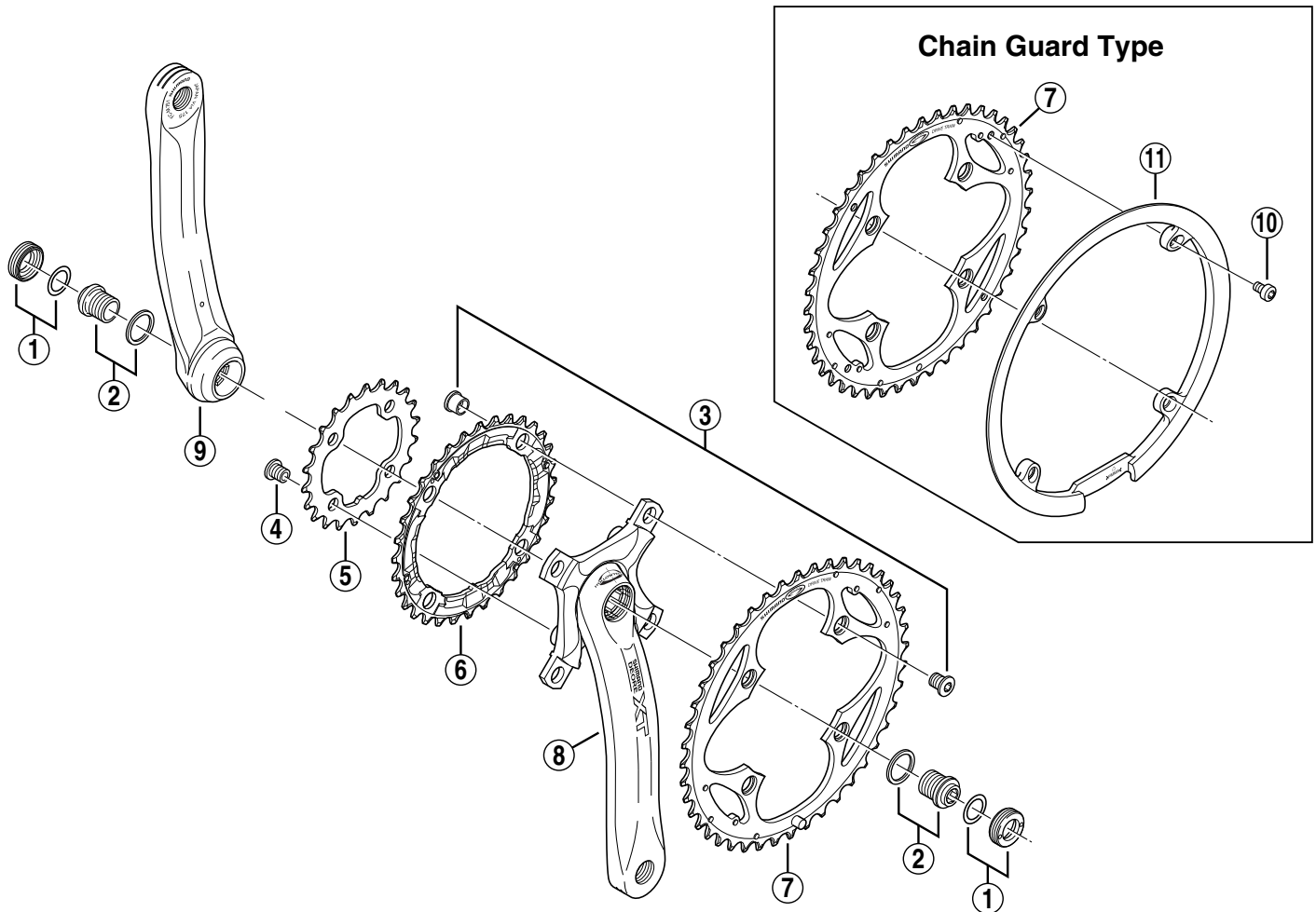

- Bolt circle diameter: 104 mm...(For outer gear and middle gear), 64 mm...(For inner gear)

ITEM NO.	SHIMANO CODE NO.	DESCRIPTION
1	Y-17L 98010	Crank Arm Cap & Plastic Washer
2	Y-17L 98020	Crank Arm Fixing Bolt & Washer
3	Y-1C6 98020	Double Gear Fixing Bolt (M8 x 9.2) & Nut (4 sets)
4	Y-1BD98030	Inner Gear Fixing Bolt (M8 x 8.5 / 4 pcs.)
5	Y-1C6 22100	Chainring 22T
6	Y-1C8 93200	Chainring 32T
7	Y-1C6 98030	Chainring 44T
	Y-1C6 94401	Chainring 44T for Chain Guard
8	Y-1DK98010	Right Hand Crank Arm 165 mm
	Y-1DK98020	Right Hand Crank Arm 167.5 mm
	Y-1DK98030	Right Hand Crank Arm 170 mm
	Y-1DK98040	Right Hand Crank Arm 172.5 mm
	Y-1DK98050	Right Hand Crank Arm 175 mm
	Y-1DK98060	Right Hand Crank Arm 177.5 mm
	Y-1DK98070	Right Hand Crank Arm 180 mm
	Y-1DK98080	Left Hand Crank Arm 165 mm
9	Y-1DK98090	Left Hand Crank Arm 167.5 mm
	Y-1DK98100	Left Hand Crank Arm 170 mm
	Y-1DK98110	Left Hand Crank Arm 172.5 mm
	Y-1DK98120	Left Hand Crank Arm 175 mm
	Y-1DK98130	Left Hand Crank Arm 177.5 mm
	Y-1DK98140	Left Hand Crank Arm 180 mm
10	Y-1BD98040	Chain Guard Fixing Bolt (4 pcs.)
11	Y-1C6 18000	Chain Guard